

W QUEEN ANNE PLAYFIELD 1st Ave W & W Blaine St

Center: 1801 1st Ave
 POOL: 16 W Howe St

Purchase: 1924 \$45,428.=GF
 1946 Center Site
 1974 Pool Site

Acreage: 7.4

Development: 1950 Community Center \$403,605. ('48 BF - \$265,000. CR; State Devel Fd \$60,000.)
 1972 Playfield enlarged & redeveloped \$807,000.FT (\$759,000.FT & \$49,000.FT (field floodlighting))
 1979 Pool \$846,701.61 Frodesen & Assoc. Contractor; Arch: Ben McAdoo

Elements: Two Levels: East - 2 floodlighted baseball fields or 2 floodlighted football/soccer fields
 West - 1 softball field, play area

Community Center:

Gym: 60'x110'=850(689) persons & lockers/showers/stage: 61'x31'	Social Rm: #1 36'x45'
	#2 26'x40' +kitchenette
	fireplaces #3 30'x56'
	#4 22'x38' +kitchenette
	Game Rm: 31'x36'
	"Graft" Rm: 18'x31'

081580 JMP

340 W. QUEEN ANNE P.F. AND SWIMMING POOL



Joint-use agreement
w/school 1964
By permit; use of School Dbl. Gym

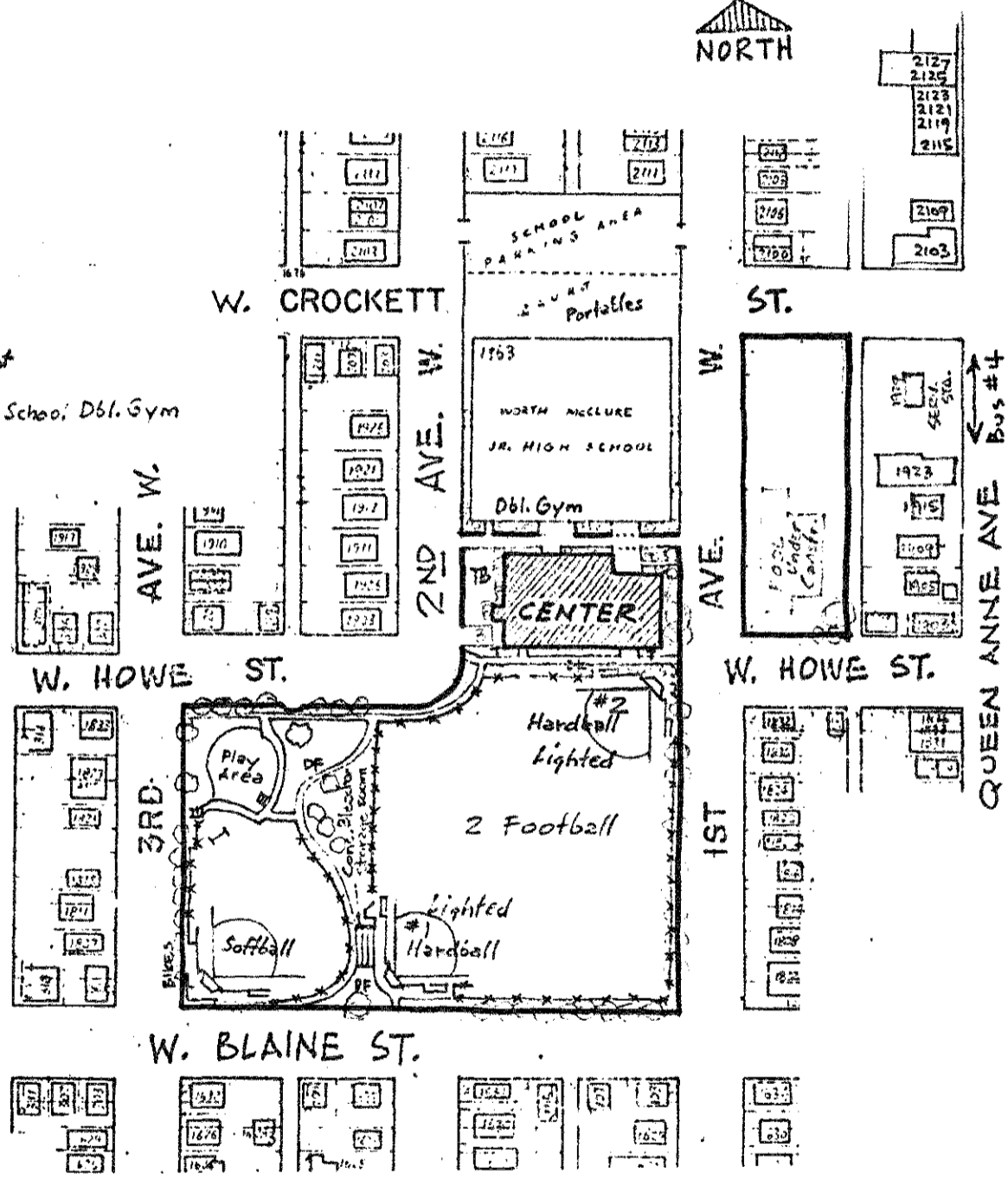

Play Areas:
Log roller
4 Swings
Fort
Slide
Climber
Sand

COMMUNITY CENTER: 1950 - \$403,605 = { 48 SF - \$265,000
CR
State Devel. Fd. \$60,000

Gym: 60' x 110' = 850 (609) persons
+ Lockers/Showers/Stage: 61' x 31'
Social Rm #1: 36' x 45' + kitchen
#2: 26' x 40'
Fireplaces #3: 30' x 56' + kitchenette
#4: 22' x 38'
Game Rm: 31' x 36'
2nd "Griff" Rm: 18' x 31'

340

7.4 Acres
Purch. 1924: \$45,428 = G.F.
"...for park, play + recr."
L.I.D. 1946: (CENTER SITE)
"...for park + playgr. use."
Purch. 1974: (POOL SITE)
"...for pl, recr. + open space..."

CENTER: 1901 - 1st Ave. W / 625 - 4040
POOL: 16 W. Howe St.

Playfield enlarged and redeveloped
as a Forward Thrust Project in 1972
\$807,000 =

W. QUEEN ANNE P.F.

21476