

ADDRESS: 6535 RAVENNA AVE N.E.  
 CONSTRUCTION COST 1.3 MILLION, 1986  
 13,000 S.F.  
 DESIGNER: ARC

PLAY EQUIP:  
 TO-FRO SWINGS  
 TIRE SWING  
 TIMBER FORM CLIMBERS  
 TWIN-SLIDES

SOFTBALL  
 BACK STOP

ART PROTECTS \$30,000  
 SPORTS RECORDS - ELLEN ZIEGLER  
 FENCE PAINTING - J. MACKIE  
 HOP SCOTCH MUSEUM " "  
 BACK STOP " "  
 SPORTS GOYLES - ELLEN ZIEGLER  
 & JACK MACKIE JOINT CONCEPT  
 EXECUTED BY E.Z.

UNDEVELOPED PARK PROPERTY  
 168' x 331'

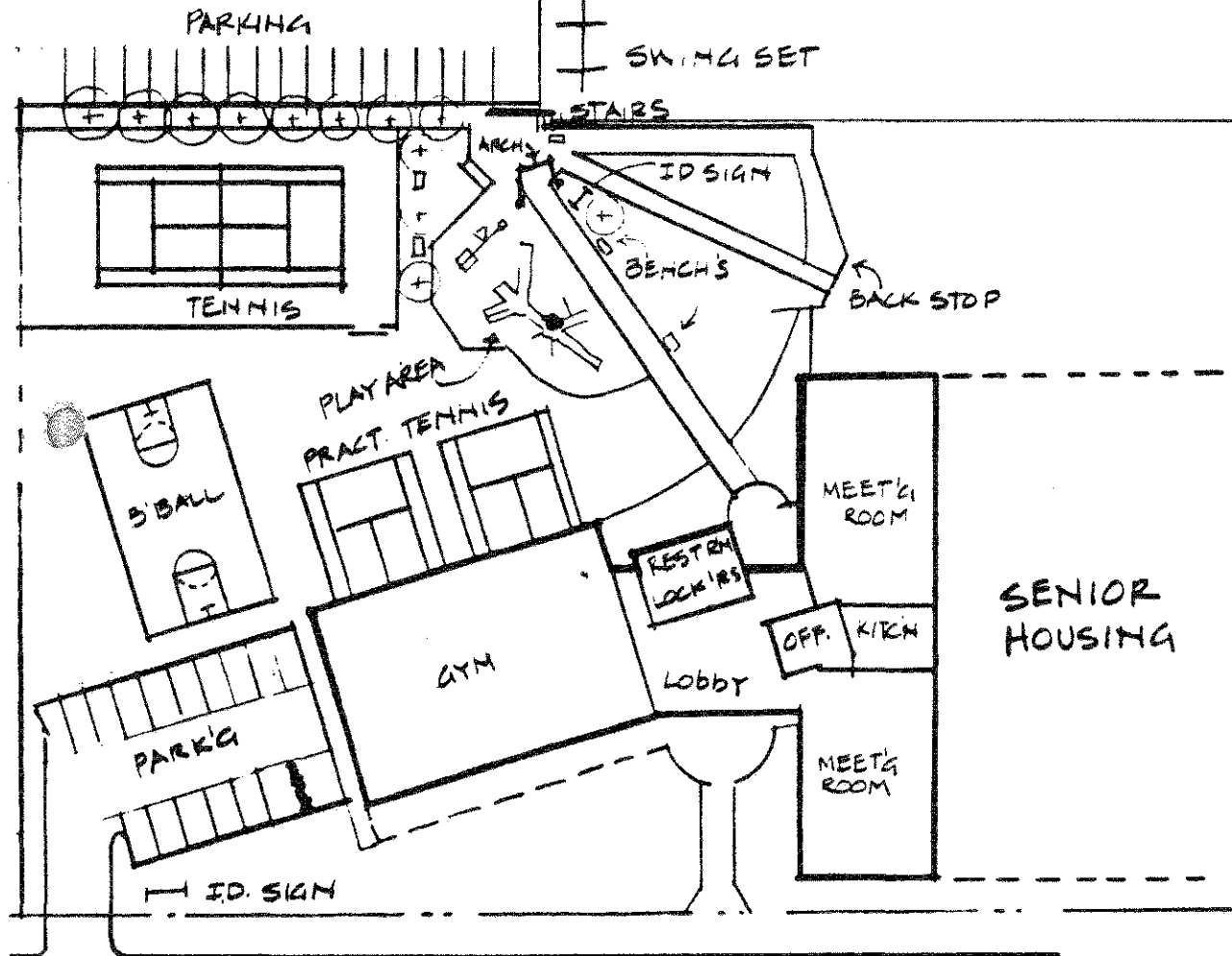

RAVENNA AVE. N.E. → NORTH

RAVENNA-ECKSTEIN  
 COMMUNITY CENTER  
 SHEET 1 OF 1



This section of the page is mostly blank, containing faint, illegible markings and a large, light-colored rectangular area at the bottom, possibly representing a signature line or a large-scale drawing area.