

# RIGHT OF WAY DESIGN OPTION FEEDBACK - SUMMARY

## ENGAGEMENT PROCESS

Feedback was collected from an online survey, that ran from March 8th to April 12th, and a Public Meeting held in partnership with Lake City Collective. Three (3) design options were presented; the survey and boards broke down the design elements and asked about preferred elements from each design option.

### OPTION A: FRONT YARD

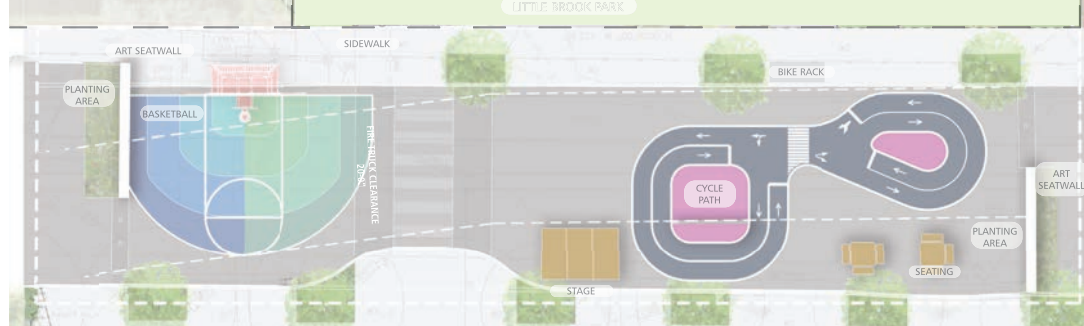

### OPTION B: PLAZA

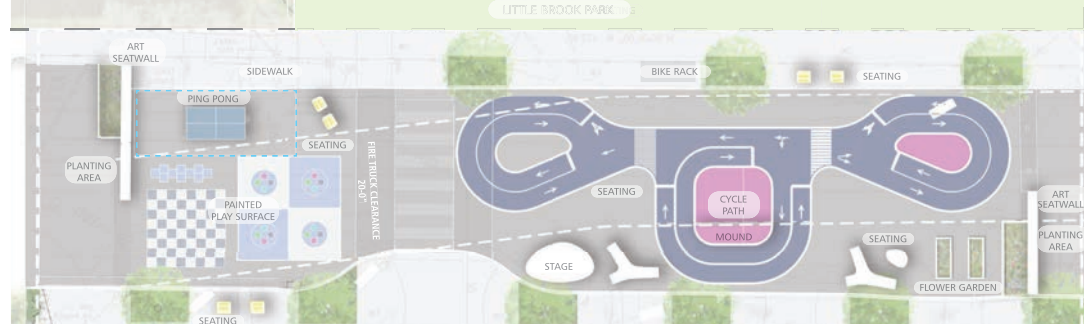

### OPTION C: URBAN

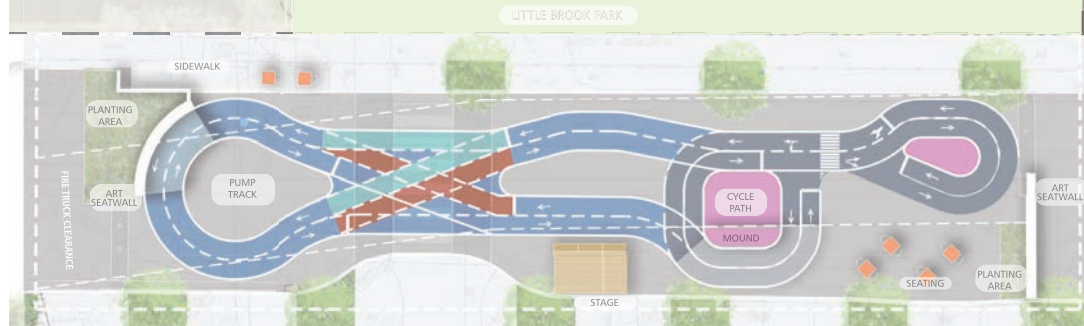

## OVERALL RANK OF DESIGN ELEMENTS

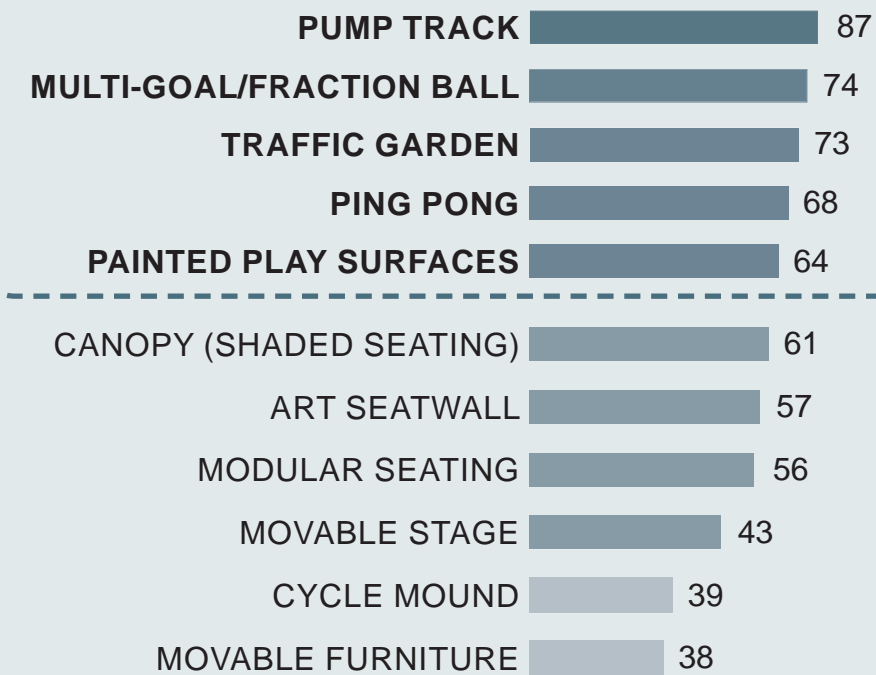

"Queremos la cancha de basketball y mesa de ping pong, jardin the trafico pequeño para tener otras activites"

"We want the basketball hoop and ping pong table, the traffic circle is small for having other activites"

"Areas to garden/ opportunities for gardening."

"Minimal, to ensure the integrity of the park's original purpose."

"Ability to support community events (food truck and vendor tents)"

"Moveable stage with space for event tents/canopies."

"Mezclan las ideas de las 3 opciones y hagan lo flexible y movil para que no se vuelva monotonu"

"Mix the ideas of the 3 options and make it flexible and movable so it doesn't become monotonous"

## PREFERRED SEATING AND SEATING ELEMENTS

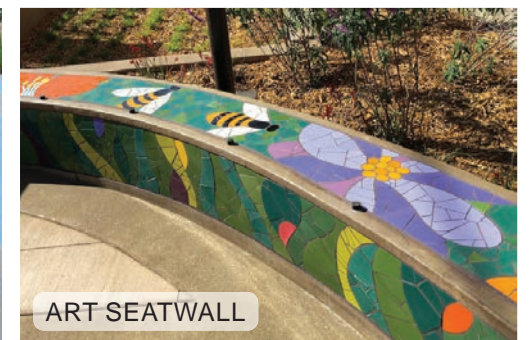
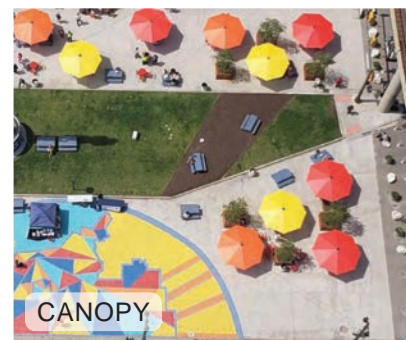

## PREFERRED PLAY ELEMENTS AND LEARNING LANDSCAPES

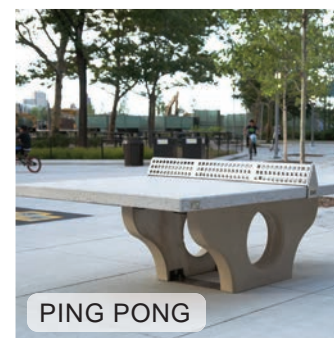

# PLAY EQUIPMENT OPTION FEEDBACK - SUMMARY

## ENGAGEMENT PROCESS

Feedback was collected from an online survey, that ran from March 8th to April 12th, and a Public Meeting held in partnership with Lake City Collective. Five (5) Play Equipment options were presented; the survey and boards asked about preferred option, what they like about the equipment, and secondary preferences.

## RANK OF OPTION C DESIGN ELEMENTS

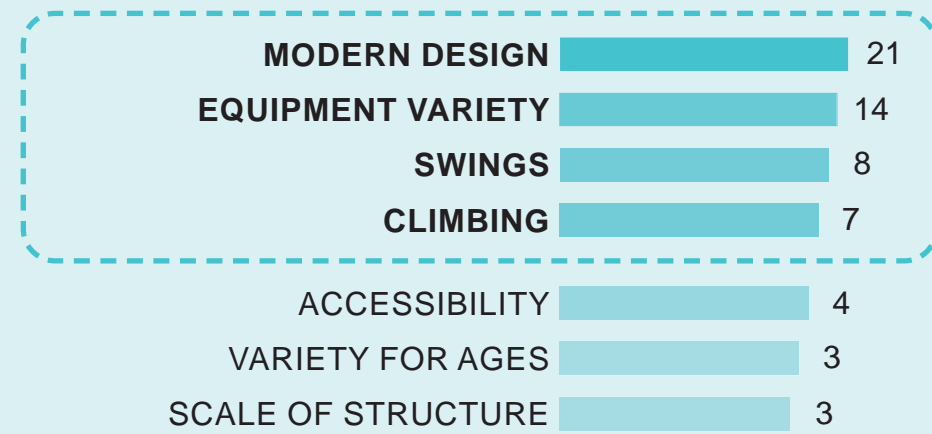

## OTHER CONSIDERATIONS

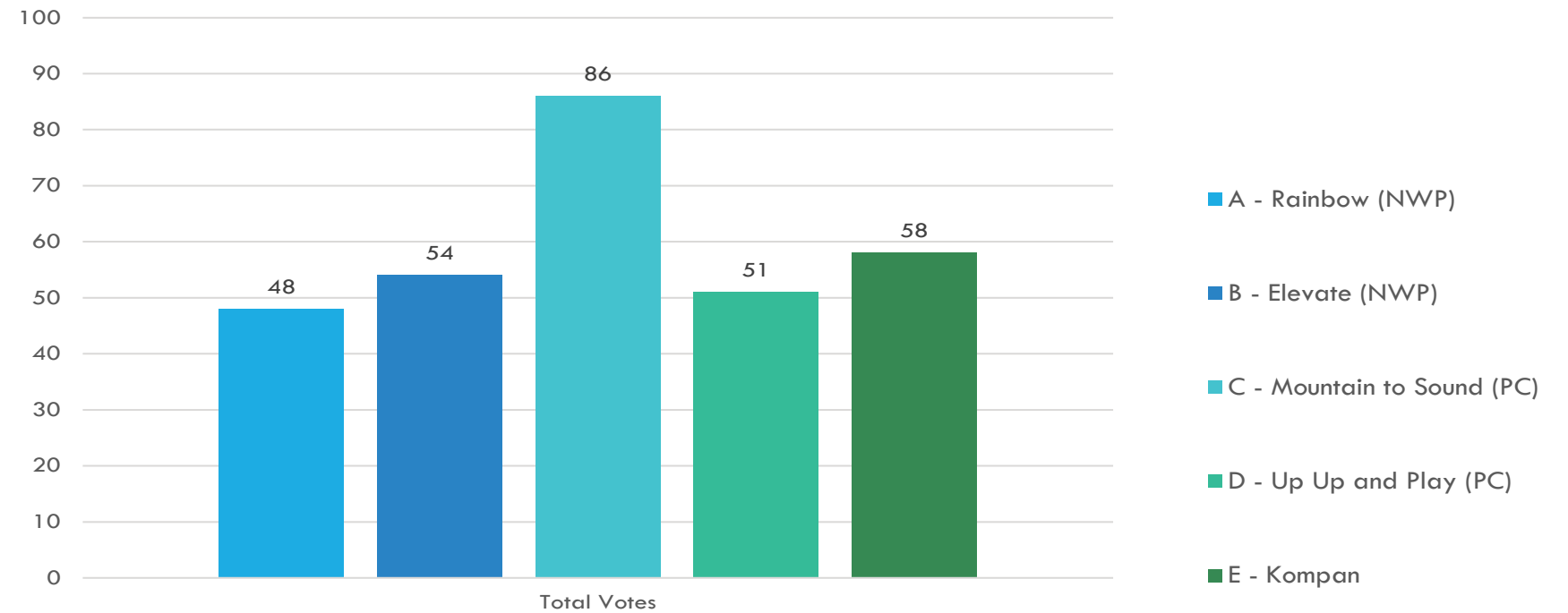
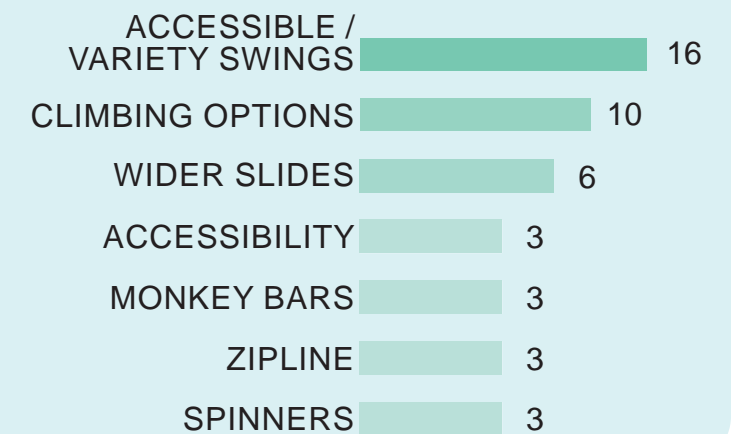

### PREFERRED OPTION

"Best combination of high climber and accessible swings"

"Climbing features and more aesthetically pleasing. The mountain looks cool for our area."

"Queremos color en la estructura del parque, nuestro vecindario es gris y queremos que al menos el parque sea colorido!"

"We want color in the play structure at the park, our neighborhood is grey and we want, at minimum, for the park to be colorful!"

"Please have many swings for all ages and weights... Also put at least the same amount of slides the actual park HAS"

"It provides exciting play options for children of a wide age range and abilities"

"As much as it is feasible, access/equipment for kids with disabilities would be amazing!"