



## FACT SHEET

# 15TH AVE S IMPROVEMENTS PROJECT

February 2020

### PROJECT DESCRIPTION

Each year, we pave arterial streets in poor condition to make them safer and smoother and to extend their useful life. Keeping our transportation system in a state of good repair helps lower the cost of future maintenance. In 2020, we'll repave about 1 mile of 15th Ave S between S Spokane St and S Angeline St and a section of S Spokane St between S Columbian Way and 18th Ave S.

The project also makes changes to the intersection of 15th Ave S and S Columbian Way. It adds protections for people biking, improved signals for people walking or rolling, and a bus stop. This design has minimal impacts to on-street parking and retains a signal for those accessing 15th Ave S from S Oregon St. A new pedestrian-friendly peninsula will be created where Oregon St crosses Columbian Way.

### WHAT'S HAPPENING NOW?

- We're reaching out to neighbors to let them know that this project is moving forward and construction will begin this year. Please sign up for our emails to receive ongoing information about this project on our website.
- The intersection update and paving are scheduled to begin construction as early as fall 2020.

### CONSTRUCTION SCHEDULE

Dates are subject to change.

**EARLY 2020** Finish design

**EARLY- TO MID-2020**

Pre-construction coordination with community

**FALL 2020** Begin construction

**2021** Complete construction

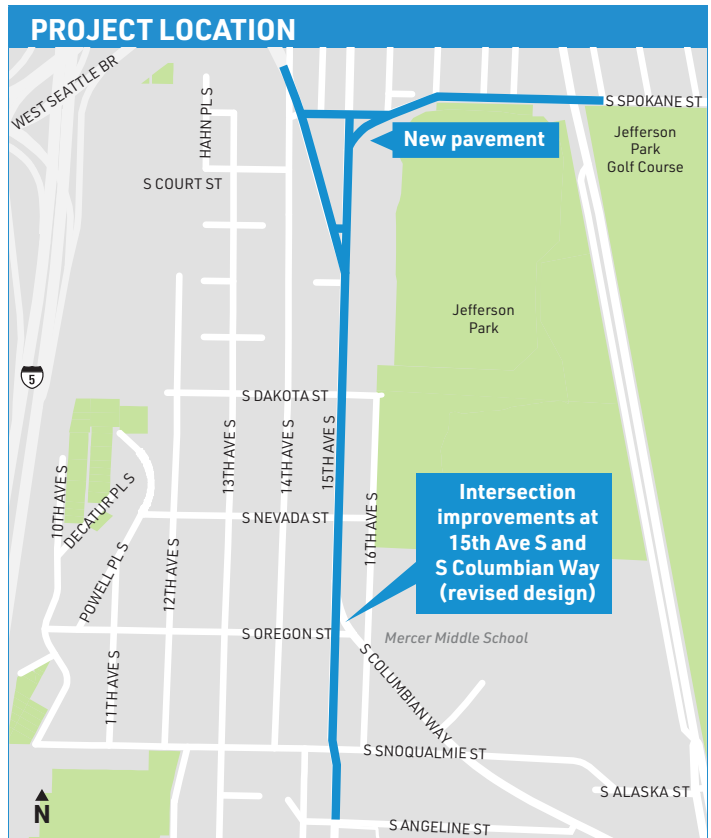

### PROJECT ELEMENTS

- New pavement
- Drainage improvements
- Upgraded pedestrian push buttons
- Upgraded curb ramps
- Improved and updated sidewalks
- 15th and Columbian intersection:
  - Pedestrian-friendly peninsula
  - New curb bulbs
  - Crossing and signal consolidation
  - Retained left turn from S Oregon St to 15th Ave S
  - Improved connections for bicycles
  - Pedestrian improvement at 15th Ave and S Spokane St

### PROJECT INFORMATION AND CONTACT

Outreach Lead: Adonis Ducksworth  
15thAveAAC@seattle.gov, (206) 775-8719  
www.seattle.gov/transportation/15th-Ave-S-AAC



Seattle  
Department of  
Transportation

The Levy to

**MOVE SEATTLE**



## PROJECT BENEFITS

- Roadway improvements
- Sidewalk repairs
- New, visible lane markings
- Increased safety at the intersection for students and other people walking, rolling and biking
- Simplified intersection for drivers
- Improved transit stops

## FUNDING

Funding comes from the 2015 voter-approved, nine-year Levy to Move Seattle, which provides funding to improve safety for all travelers, maintain streets and bridges, and invest in reliable, affordable travel options for a growing city.

This project also is receiving funding from SDOT's Safe Routes to School program, which makes it easier and safer for students to walk and bike in Seattle, as well as funding from our paving program.

## NEED A TRANSLATION?

If you need this information translated, please call (206) 684-4193.

Servicios de traducción e interpretación disponibles bajo petición (206) 684-4193.

Matutulungan ka naming maintindihan kung hihingi kang tulong (206) 684-4193.

요청하시면 번역이나 통역을 제공해드립니다 (206) 684-4193.

Dịch và thông dịch viên sẵn sàng nếu có sự yêu cầu (206) 684-4193.

Haddii aad dooneyso turjubeen fadlen wac (206) 684-4193.

## INTERSECTION DESIGN

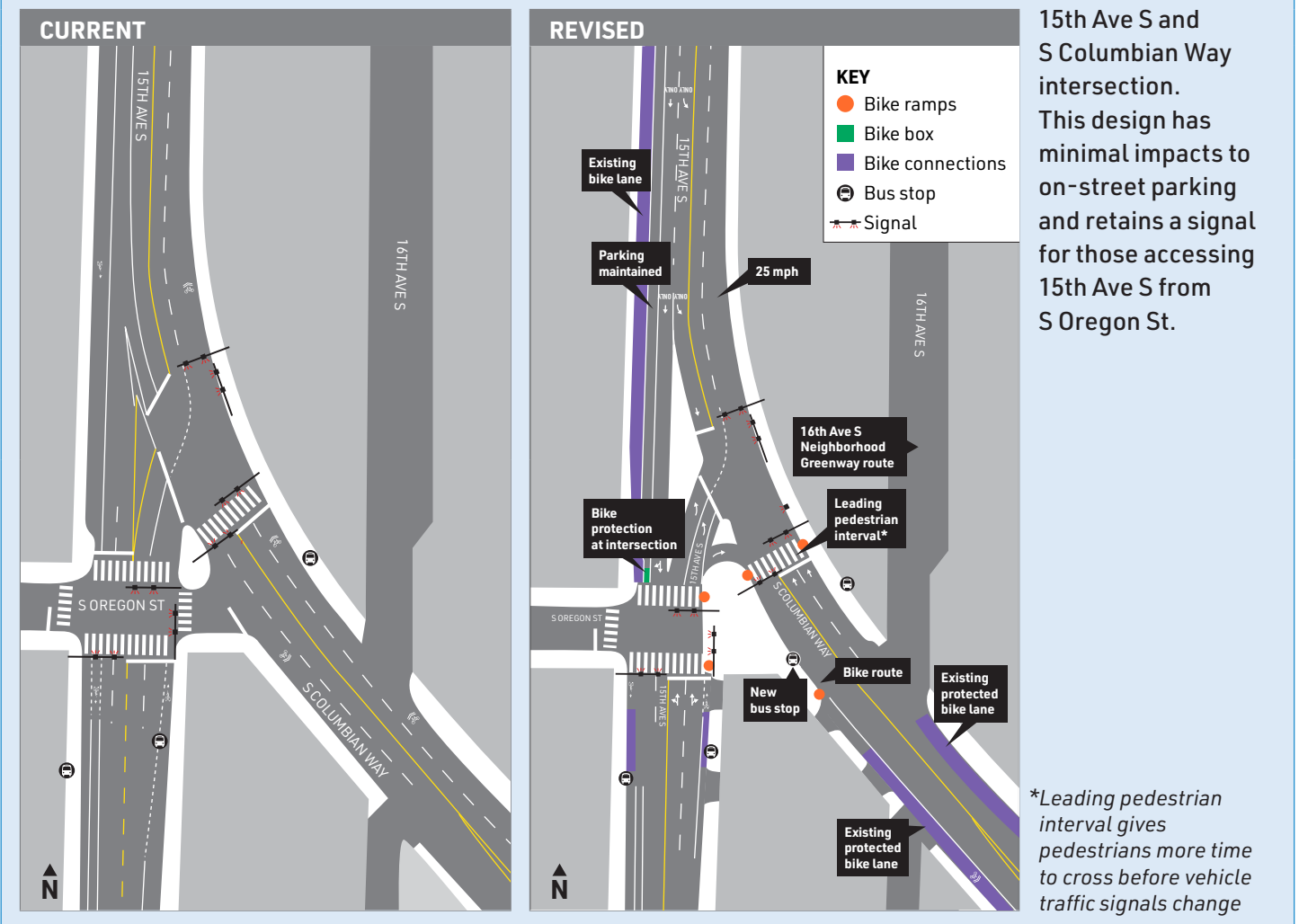

## PROJECT INFORMATION AND CONTACT

Outreach Lead: Adonis Ducksworth  
 15thAveAAC@seattle.gov, (206) 775-8719  
[www.seattle.gov/transportation/15th-Ave-S-AAC](http://www.seattle.gov/transportation/15th-Ave-S-AAC)

